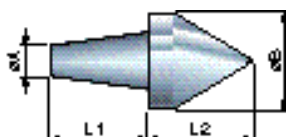
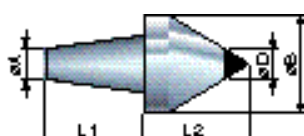
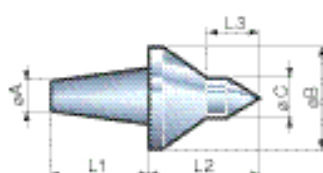
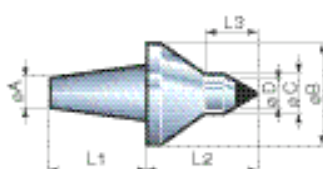
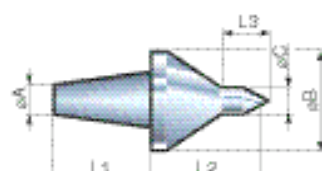
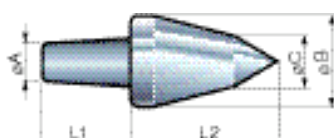

1

 Cuspidi intercambiabili a 60° per tutti i modelli di contropunta con albero intercambiabile
 60° interchangeable tips for all models of centres with interchangeable shaft

Mod. 30

Mod. 31/MD

Mod. 40A

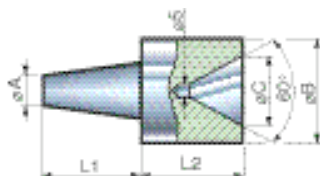
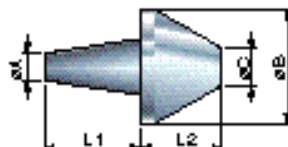
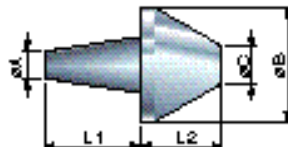
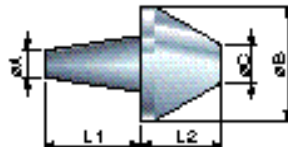
Mod. 41A/MD

Mod. 40B

Mod. 42

Cono Morse Taper	L 1	L 2	L 3	ø A	ø B	ø C	ø D	CODICE/CODE
C 2	27	28		10,4	25			80 30 30
C 3	27	28		10,4	25			80 30 30
C 4	29	31		12	29			80 30 40
C 5	30	36		17,2	35			80 30 50
C 6	33	45		18,5	42			80 30 60
C 6	40	46		23,6	43			80 30 60 F
C 2	27	28		10,4	25	10		80 31 30
C 3	27	28		10,4	25	10		80 31 30
C 4	29	31		12	29	12		80 31 40
C 5	30	36		17,2	35	14		80 31 50
C 6	33	45		18,5	42	14		80 31 60
C 6	40	46		23,6	43	14		80 31 60 F
C 2	27	34	16	10,4	25	12		80 40 13
C 3	27	34	16	10,4	25	12		80 40 13
C 4	29	37	16	12	29	12		80 40 14
C 5	30	42	19	17,2	35	15		80 40 15
C 6	33	54	25	18,5	42	20		80 40 16
C 6	40	62	33	23,6	43	20		80 40 16 F
C 2	27	34	16	10,4	25	12	7	80 41 13
C 3	27	34	16	10,4	25	12	7	80 41 13
C 4	29	37	16	12	29	12	8	80 41 14
C 5	30	42	19	17,2	35	15	12	80 41 15
C 6	33	54	25	18,5	42	20	12	80 41 16
C 6	40	62	33	23,6	43	20	12	80 41 16 F
C 2	27	34	12	10,4	25	7		80 40 23
C 3	27	34	12	10,4	25	7		80 40 23
C 4	29	37	12	12	29	7		80 40 24
C 5	30	42	12	17,2	35	7		80 40 25
C 6	33	54	18	18,5	42	12		80 40 26
C 6	40	62	26	23,6	43	12		80 40 26 F
C 2	27	45		10,4	25	8		80 42 30
C 3	27	45		10,4	25	8		80 42 30
C 4	29	50		12	29	10		80 42 40
C 5	30	59		17,2	35	12		80 42 50
C 6	33	75		18,5	42	12		80 42 60
C 6	40	75		23,6	43	12		80 42 60 F

Cuspidi intercambiabili 60° per tutti i modelli di contropunta con albero intercambiabile
 60° interchangeable tips for all models of centres with interchangeable shaft

Mod. 50

Mod. 60

Mod. 80

Mod. 100

Cono Morse Taper	L 1	L 2	ø A	ø B	ø C	ø D	CODICE / CODE
C 2	27	30	10,4	29	23		80 50 30
C 3	27	30	10,4	29	23		80 50 30
C 4	29	30	12	29	23		80 50 40
C 5	30	35	17,2	35	27		80 50 50
C 6	33	35	18,5	37	27		80 50 60
C 6	40	46	23,6	37			80 50 60 F
C 2	27	35	10,4	59	26		80 60 30
C 3	27	35	10,4	59	26		80 60 30
C 4	29	35	12	59	26		80 60 40
C 5	30	35	17,2	59	26		80 60 50
C 6	33	35	18,5	59	26		80 60 60
C 6	40	35	23,6	59	26		80 60 60 F
C 2	27	35	10,4	78	46		80 80 30
C 3	27	35	10,4	78	46		80 80 30
C 4	29	35	12	78	46		80 80 40
C 5	30	35	17,2	78	46		80 80 50
C 6	33	35	18,5	78	46		80 80 60
C 6	40	35	23,6	78	46		80 80 60 F
C 2	27	35	10,4	98	66		80 100 3
C 3	27	35	10,4	98	66		80 100 3
C 4	29	35	12	98	66		80 100 4
C 5	30	35	17,2	98	66		80 100 5
C 6	33	35	18,5	98	66		80 100 6
C 6	40	35	23,6	98	66		80 100 6 F

Per la richiesta di cuspidi con dimensioni personalizzate compilare la tabella sotto e spedire tramite telefax.

When you ask for tips with personalized dimensions always fill in this table and fax it.

Cono Morse Tape	L1	L2	ø A	ø B	ø C	ø D	Mod.	ø di lavoro working ø	Peso pezzo Piece weight