

»» 05 CAT

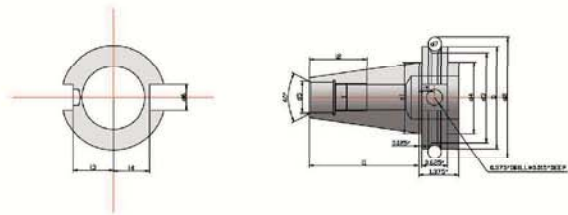

Taper Standard

ANSI B5.50



Model	D	d1	d2	d3	d4	d5	d6	d7	l1	l2	l3	l4	l5	T
CAT30	1.812	1.25	2.176	1.531	1.25	0.516	0.645	0.2813	1.875	0.188	0.735	0.64	0.44	1/2-12
CAT40	2.500	1.75	2.863	2.219	1.75	0.641	0.645	0.2813	2.687	0.188	0.985	0.89	0.44	5/8-11
CAT50	3.875	2.75	4.238	3.594	2.75	1.031	1.020	0.2813	4.000	0.250	1.485	1.39	0.44	1-8

Material: Allied case hardened steel, black-finished and precisely grinded
 Taper tolerance: <AT3
 Hardness: HRC 56-58
 Carbon depth: 0.8mm±0.2mm
 Max run out: <0.005mm
 Surface Roughness: Ra<0.005mm
 Cooling AD+B type can be made by request
 When Order, please specify balancing G6.3 or G2.5.
 Shank body standard: ANSI B5.50

Cooling

Form A: without cooling supply
 Form AD: central cooling supply
 Form AD+B: central cooling and internal coolant through the collar

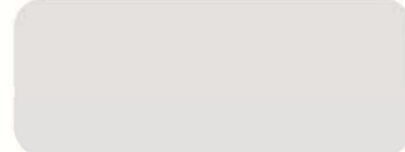
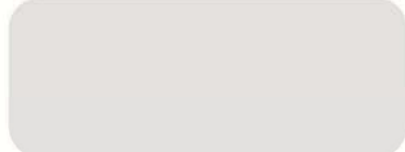
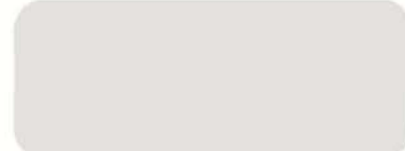
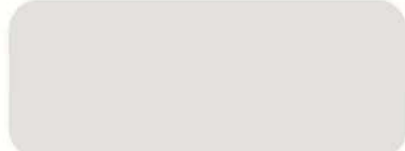
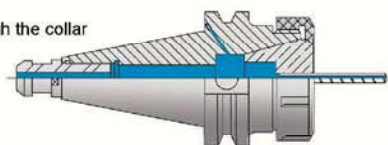

ER Collet Chuck DIN6499

ANSI B5.50

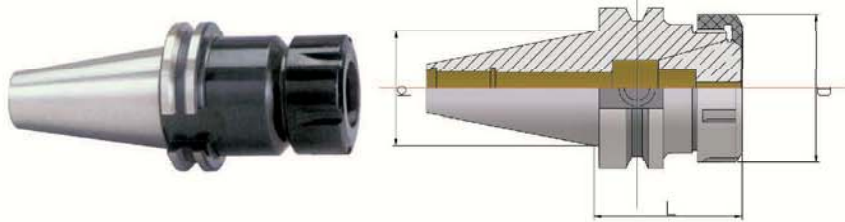

Order No.	Model	D	d	Clamping range
55401670	CAT40xER16-70	28	44.45	0.5-10
554016100	CAT40xER16-100	28	44.45	0.5-10
554016120	CAT40xER16-120	28	44.45	0.5-10
55402070	CAT40xER20-70	35	44.45	0.5-13
554020100	CAT40xER20-100	35	44.45	0.5-13
55402570	CAT40xER25-70	42	44.45	0.5-16
554025100	CAT40xER25-100	42	44.45	0.5-16
554025150	CAT40xER25-150	42	44.45	0.5-16
55403270	CAT40xER32-70	50	44.45	1-20
554032100	CAT40xER32-100	50	44.45	1-20
554032120	CAT40xER32-120	50	44.45	1-20
554032150	CAT40xER32-150	50	44.45	1-20
554040100	CAT40xER40-100	63	44.45	2-26
554040120	CAT40xER40-120	63	44.45	2-26

Use: For clamping tools with straight shank in collets of DIN 6499



ER Collet Chuck DIN6499

ANSI B5.50

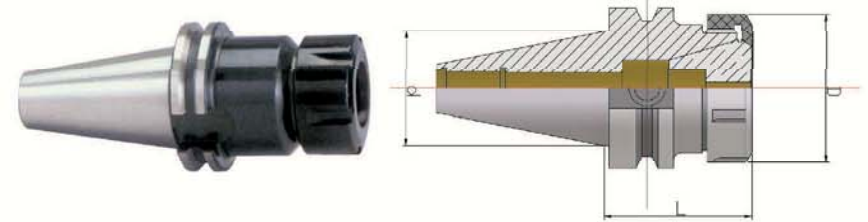

Order No.	Model	D	d	Clamping range
55501680	CAT50xER16-80	28	69.85	0.5-10
55502080	CAT50xER20-80	35	69.85	0.5-13
55502090	CAT50xER20-90	35	69.85	0.5-13
555020105	CAT50xER20-105	35	69.85	0.5-13
555020150	CAT50xER20-150	35	69.85	0.5-13
55502580	CAT50xER25-80	42	69.85	0.5-16
555025105	CAT50xER25-105	42	69.85	0.5-16
555025135	CAT50xER25-135	42	69.85	0.5-16
55503280	CAT50xER32-80	50	69.85	1-20
555032100	CAT50xER32-100	50	69.85	1-20
555032120	CAT50xER32-120	50	69.85	1-20
55504080	CAT50xER40-80	63	69.85	2-26
555040100	CAT50xER40-100	63	69.85	2-26
555040120	CAT50xER40-120	63	69.85	2-26

Use: For clamping tools with straight shank in collets of DIN 6499



Precision Milling Chuck

ANSI B5.50

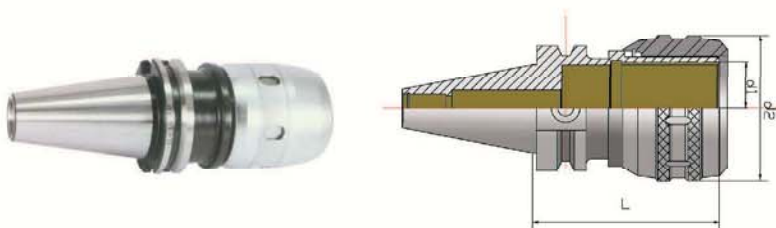

Order No.	Model	d1	d2	L	Wt(kg)
55400.75"86C	CAT40-SC3/4"-3.385"	3/4"	2.17	3.39"	1.9
55400.75"105C	CAT40-SC3/4"-4.13"	3/4"	2.17	4.13"	2.1
55401.25"115C	CAT40-SC1-1/4"-4.53"	1.25"	2.87	4.53"	2.4
55500.75"105C	CAT50-SC3/4"-4.13"	3/4"	2.17	4.13"	2.5
55501.25"105C	CAT50-SC1-1/4"-4.13"	1.25"	2.87	4.13"	2.8

Use: For mounting straight shank tools in collets; to use for high speed cutting and high precision milling



OZ Collet Chuck DIN6391

ANSI B5.50

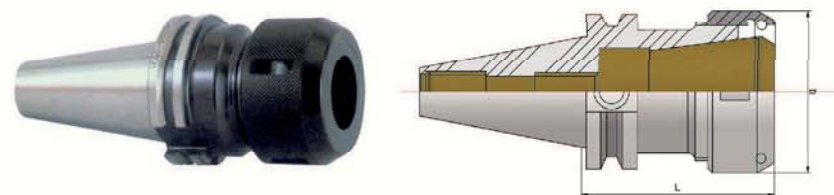

Order No.	Model	D1	L	L1	D	Collet Type
554025 2.25"OZ	CAT40-OZ25-2.25"	1/8"-1"	2.25"	1.18"	2.36"	OZ25
554025 4.00"OZ	CAT40-OZ25-4.00"	1/8"-1"	4.00"	1.18"	2.36"	OZ25
554032 2.25"OZ	CAT40-OZ32-2.25"	1/4"-1-1/4"	2.25"	1.30"	2.83"	OZ32
554032 4.00"OZ	CAT40-OZ32-4.00"	1/4"-1-1/4"	4.00"	1.30"	2.83"	OZ32
555025 2.25"OZ	CAT50-OZ25-2.25"	1/8"-1"	2.25"	1.18"	2.36"	OZ25
555025 4.00"OZ	CAT50-OZ25-4.00"	1/8"-1"	4.00"	1.18"	2.36"	OZ25
555032 2.25"OZ	CAT50-OZ32-2.25"	1/4"-1-1/4"	2.25"	1.30"	2.83"	OZ32
555032 4.00"OZ	CAT50-OZ32-4.00"	1/4"-1-1/4"	4.00"	1.30"	2.83"	OZ32

Use: For clamping tools with straight shank in collets of DIN6388



FMA FACE MILL HOLDER

ANSI B5.50

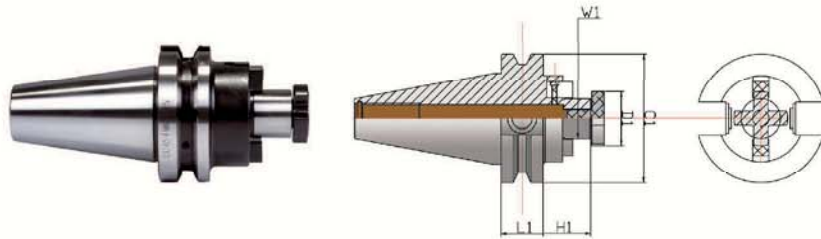

Order No.	Model	D1	L1	H1	C1	W1
5540254L175FA	CAT40-FMA25.4-1.75"	25.4(1")	1.75"	17.5	2.362"	9.5(0.374")
55403175L2FA	CAT40-FMA31.75-2"	31.75(1.25")	2"	17.5	2.756"	12.7(0.5")
5540381L2FA	CAT40-FMA38.1-2"	38.1(1.5")	2"	23.8	3.346"	15.9(0.626")
5550254L175FA	CAT50-FMA25.4-1.75"	25.4(1")	1.75"	17.5	2.362"	9.5(0.374")
5550254L4FA	CAT50-FMA25.4-4"	25.4(1")	4"	17.5	2.362"	9.5(0.374")
5550254L6FA	CAT50-FMA25.4-6"	25.4(1")	6"	17.5	2.362"	9.5(0.374")
55503175L175FA	CAT50-FMA31.75-1.75"	31.75(1.25")	1.75"	17.5	2.756"	12.7(0.5")
55503175L4FA	CAT50-FMA31.75-4"	31.75(1.25")	4"	17.5	2.756"	12.7(0.5")
55503175L6FA	CAT50-FMA31.75-6"	31.75(1.25")	6"	17.5	2.756"	12.7(0.5")
5550381L2FA	CAT50-FMA38.1-2"	38.1(1.5")	2"	23.8	3.346"	15.9(0.626")
5550381L4FA	CAT50-FMA38.1-4"	38.1(1.5")	4"	23.8	3.346"	15.9(0.626")
5550381L6FA	CAT50-FMA38.1-6"	38.1(1.5")	6"	23.8	3.346"	15.9(0.626")
5550508L2FA	CAT50-FMA50.8-2"	50.8(2")	2"	24	3.74"	19.05(0.75")
5550508L4FA	CAT50-FMA50.8-4"	50.8(2")	4"	24	3.74"	19.05(0.75")
5550508L6FA	CAT50-FMA50.8-6"	50.8(2")	6"	24	3.74"	19.05(0.75")
555047625L3FA	CAT50-FMA47.625-3"	47.625(1.875")	3"	32	5.26"	25.4(1")

Use: For holding like shell mill cutters



MTA Morse Taper Adapter DIN6383

ANSI B5.50

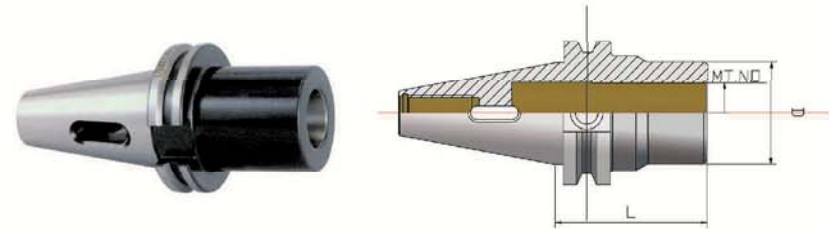

Order No.	Model	MT.No.	L	D	Wt(kg)
334045MA1	CAT40-MTA1-45	1	45	25	1.3
334063MA2	CAT40-MTA2-63	2	63	32	1.7
334075MA3	CAT40-MTA3-75	3	75	40	2
3340100MA4	CAT40-MTA4-100	4	100	48	2.5
335040MA1	CAT50-MTA1-40	1	40	25	4
335050MA2	CAT50-MTA2-50	2	50	32	4
3350135MA2	CAT50-MTA2-135	2	135	32	4.4
335063MA3	CAT50-MTA3-63	3	63	40	4.2
3350150MA3	CAT50-MTA3-150	3	150	40	4.7
335065MA4	CAT50-MTA4-65	4	65	48	4.3
335085MA4	CAT50-MTA4-85	4	85	48	4.8
3350105MA5	CAT50-MTA5-105	5	105	65	4.9

Use: For holding tools with Morse tapers and tang according to DIN228-1 form A



MTB Morse Taper Adapter (with Drawbar) DIN6364

ANSI B5.50

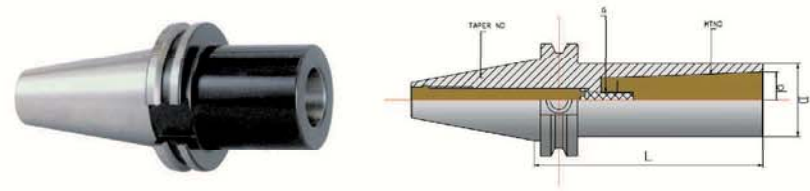

Order No.	Model	MT.No.	L	d	D	G	Wt(kg)
554050MB1	CAT40-MTB1-50	1	50	12.065	25	M6x1	1
554050MB2	CAT40-MTB2-50	2	50	17.78	32	M10x1.5	1.1
554070MB3	CAT40-MTB3-70	3	70	23.825	40	M12x1.75	1.2
5540095MB4	CAT40-MTB4-95	4	95	31.267	50	M16x2	1.3
554550MB1	CAT45-MTB1-50	1	50	12.065	25	M6x1	2.4
554560MB2	CAT45-MTB2-60	2	60	17.78	32	M10x1.5	2.4
554565MB3	CAT45-MTB3-65	3	65	23.825	40	M12x1.75	2.4
554570MB4	CAT45-MTB4-70	4	70	31.267	50	M16x2	2.5
555050MB1	CAT50-MTB1-50	1	50	12.065	25	M6x1	3.9
555060MB2	CAT50-MTB2-60	2	60	17.78	32	M10x1.5	3.9
555065MB3	CAT50-MTB3-65	3	65	23.825	40	M12x1.75	3.9
555070MB4	CAT50-MTB4-70	4	70	31.267	50	M16x2	3.9

Use: For clamping tools with Morse tapers and drawbar thread according to DIN228-1 form B



6.16

Side Lock End Mill Holder DIN6359/1835B (Weldon)

ANSI B5.50

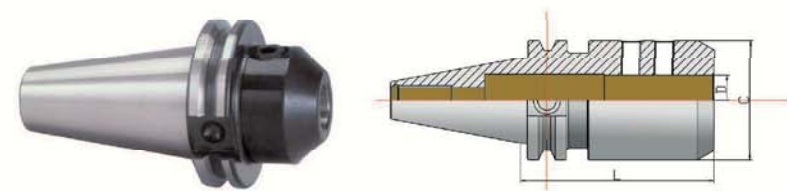

Order No.	Model	D	C	L
55400650SA	CAT40-SLA6-50	6	25	50
55400850SA	CAT40-SLA8-50	8	28	50
55401050SA	CAT40-SLA10-50	10	35	50
55401250SA	CAT40-SLA12-50	12	42	50
55401663SA	CAT40-SLA16-63	16	48	63
55402063SA	CAT40-SLA20-63	20	52	63
554025100SA	CAT40-SLA25-100	25	65	100
554032100SA	CAT40-SLA32-100	32	72	100
55500663SA	CAT50-SLA6-63	6	25	63
55500863SA	CAT50-SLA8-63	8	28	63
55501063SA	CAT50-SLA10-63	10	35	63
55501263SA	CAT50-SLA12-63	12	42	63
55501663SA	CAT50-SLA16-63	16	48	63
55502063SA	CAT50-SLA20-63	20	52	63
55502580SA	CAT50-SLA25-80	25	65	80
555032100SA	CAT50-SLA32-100	32	72	100
555040120SA	CAT50-SLA40-120	40	90	120
555050130SA	CAT50-SLA50-130	50	100	130

Use: For clamping cutters with straight shank and inclined flat of DIN1835-B and DIN6535-HB



6.16

APU Drill Chuck Holder APU

ANSI B5.50

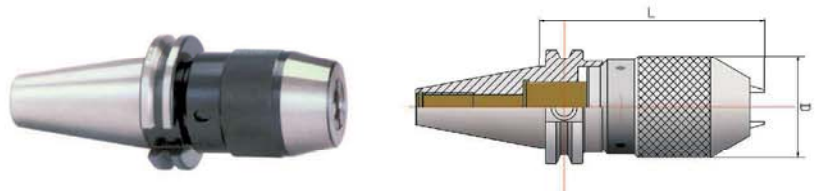

Order No.	Model	Clamping Range	D	L	
				Min	Max
55400865A	CAT40-APU08	1-8	36.3	65	76.5
55401388A	CAT40-APU13	1-13	51.5	88	99
554016106A	CAT40-APU16	3-16	58	106	120
55500870A	CAT50-APU08	1-8	36.3	70	77.5
55501389A	CAT50-APU13	1-13	51.5	89	100
55501696A	CAT50-APU16	3-16	58	96	110

Use: For clamping tools with straight shank



6.16